

## Roe Highway / Berkshire Road Interchange

The Gateway WA Alliance was originally commissioned to undertake the construction of the \$1 billion Gateway WA Perth Airport and Freight Access Project. Further to this project scope, the Alliance has been engaged to deliver additional work packages outside of the project zone, which will provide further benefits to road users and the local community.

### THE NEED TO UPGRADE

As one of the state's worst black spots, the intersection of Roe Highway and Berkshire Road can become heavily congested with over 40,000 vehicles using this intersection each day. Roe Highway is also used by heavy vehicles travelling to and from major industrial areas including the Perth Airport.

### THE FUTURE INTERCHANGE

The Roe Highway / Berkshire Road intersection will be upgraded to a grade separated interchange, where Roe Highway traffic will travel over the top of Berkshire Road, allowing a free-flow movement. This upgrade will offer improved safety at the interchange and will alleviate congestion.

As part of the Roe Highway / Berkshire Road interchange, Berkshire Road will have a "tennis ball" configuration which is the first time this type of design is being used in Australia. The innovative design aims at improving road user safety.

It generally can be described as being similar to a roundabout under signal control but right-turn traffic movements from Berkshire Road cut through the roundabout to and from the ramps.

Pedestrian movement at the interchange will be under signal control. The design was prompted as a Safe Systems initiative, aimed at improving road user safety.

This will be achieved through decreasing the severity of potential impacts by a change in incident angle and a reduction in approach speed.

- Berkshire Road will be about 1.5 metres lower than the existing ground level.
- Roe Highway will have a maximum height of around 8.4 metres.
- As a reference, the highest level of the original footbridge at the intersection (now removed) was approximately 250mm higher than the new bridge that will carry Roe Highway over Berkshire Road.

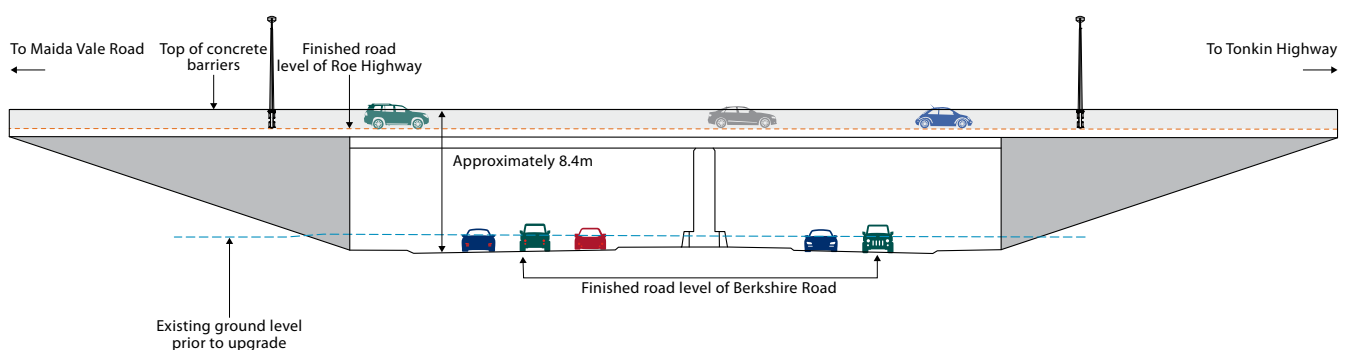

Sketch showing a typical elevation of the upgraded Roe Highway / Berkshire Road interchange looking south along Berkshire Road



Australian Government



WWW.GETTHE  
BIGGERPICTURE.COM

# ROE HIGHWAY / BERKSHIRE ROAD

## NORTHBOUND / SOUTHBOUND MOVEMENTS

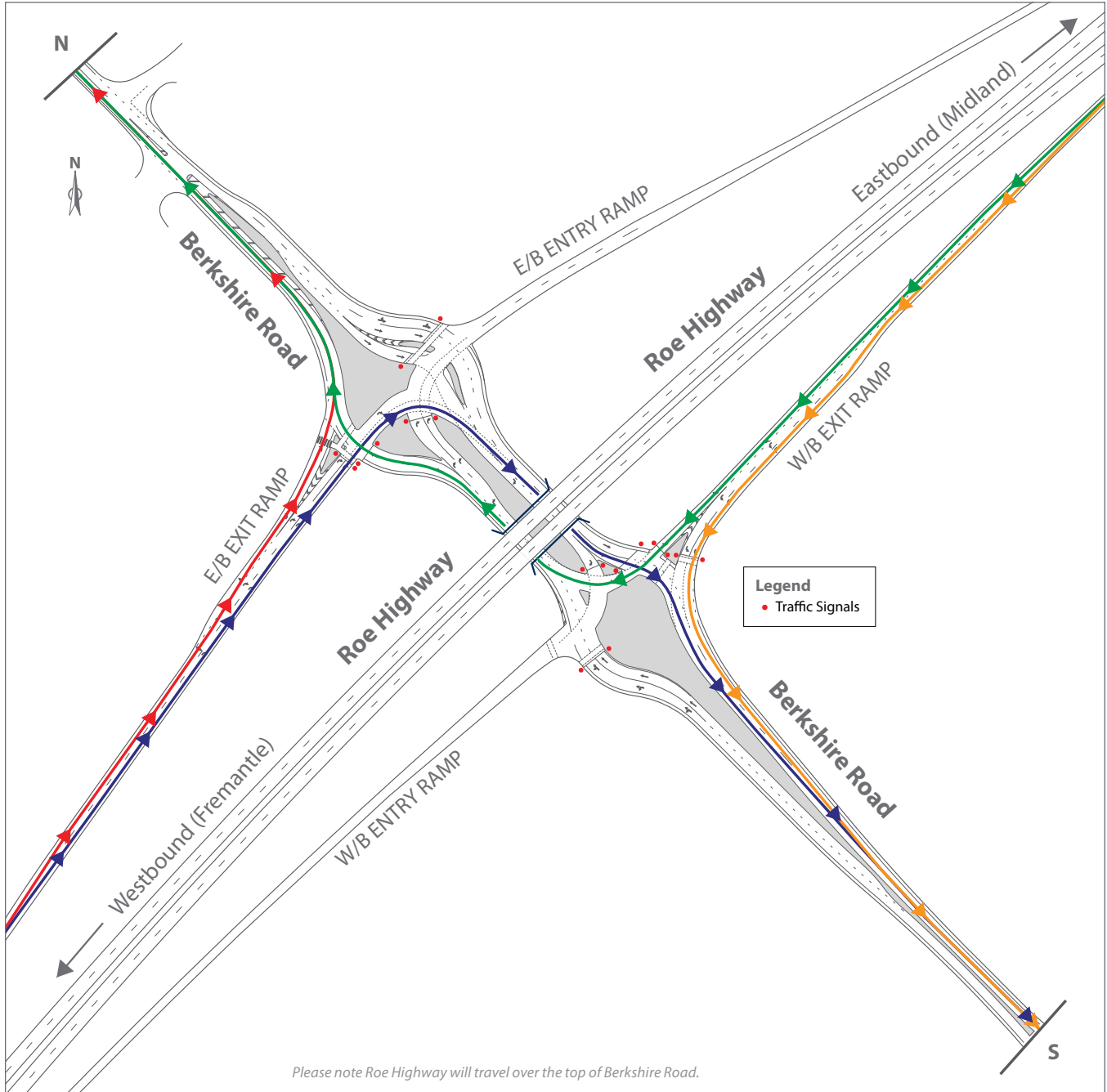

### Roe Highway eastbound to Berkshire Road northbound

- Movement under the control of give way
- 100km/h – 50km/h

### Roe Highway westbound to Berkshire Road northbound

- Movement under the control of traffic signals
- 100km/h – 50km/h

### Roe Highway eastbound to Berkshire Road southbound

- Movement under the control of traffic signals
- 100km/h – 50km/h

### Roe Highway westbound to Berkshire Road southbound

- Movement under the control of traffic signals
- 100km/h – 50km/h

# BIRKSHIRE ROAD INTERCHANGE

## EASTBOUND / WESTBOUND MOVEMENTS

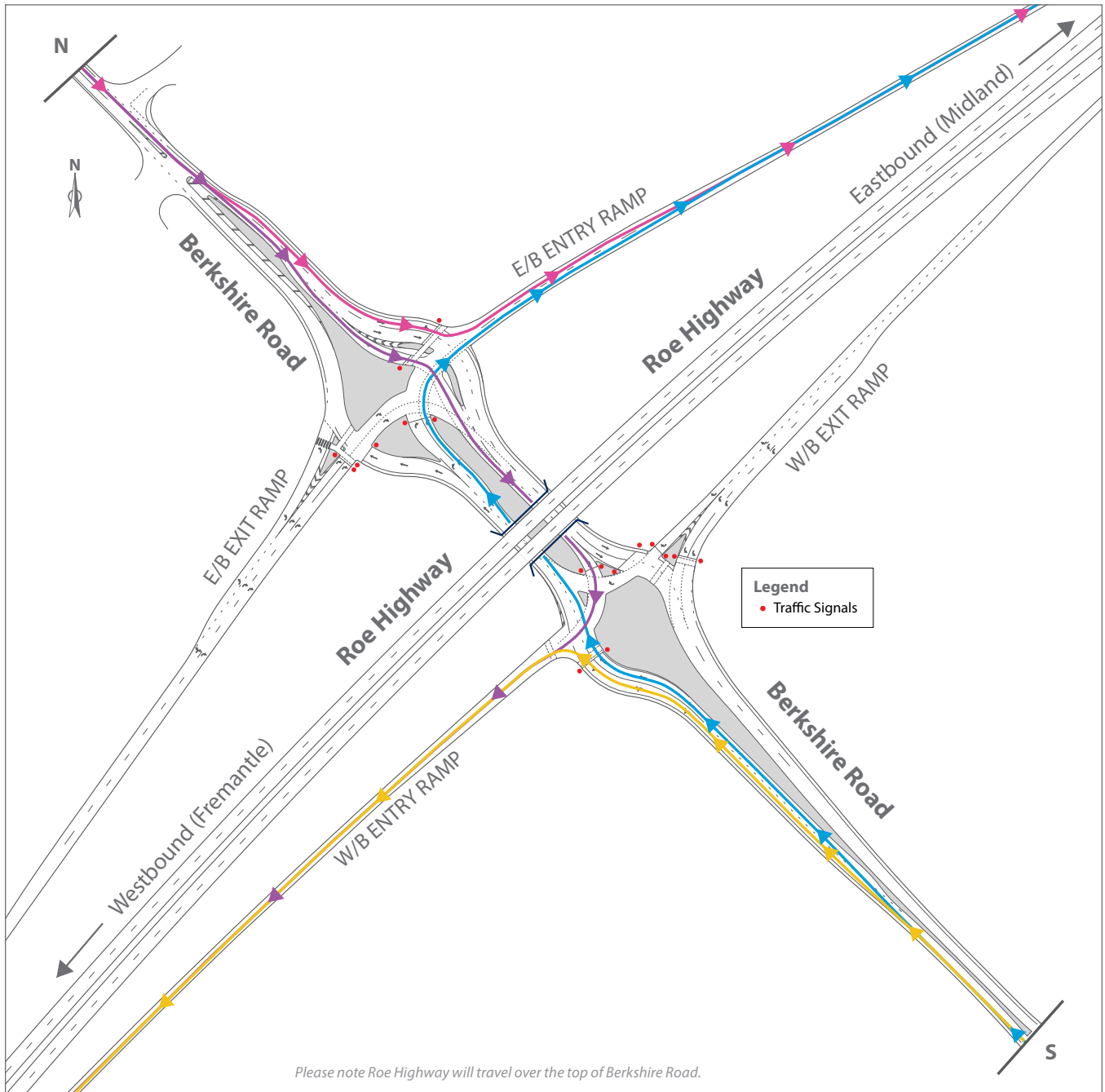

### Berkshire Road northbound to Roe Highway westbound

- Movement under the control of traffic signals
- 50km/h – 100km/h

### Berkshire Road northbound to Roe Highway eastbound

- Movement under the control of traffic signals
- 50km/h – 100km/h

### Berkshire Road southbound to Roe Highway eastbound

- Movement under the control of traffic signals
- 50km/h – 100km/h

### Berkshire Road southbound to Roe Highway westbound

- Movement under the control of traffic signals
- 50km/h – 100km/h

# FACILITIES

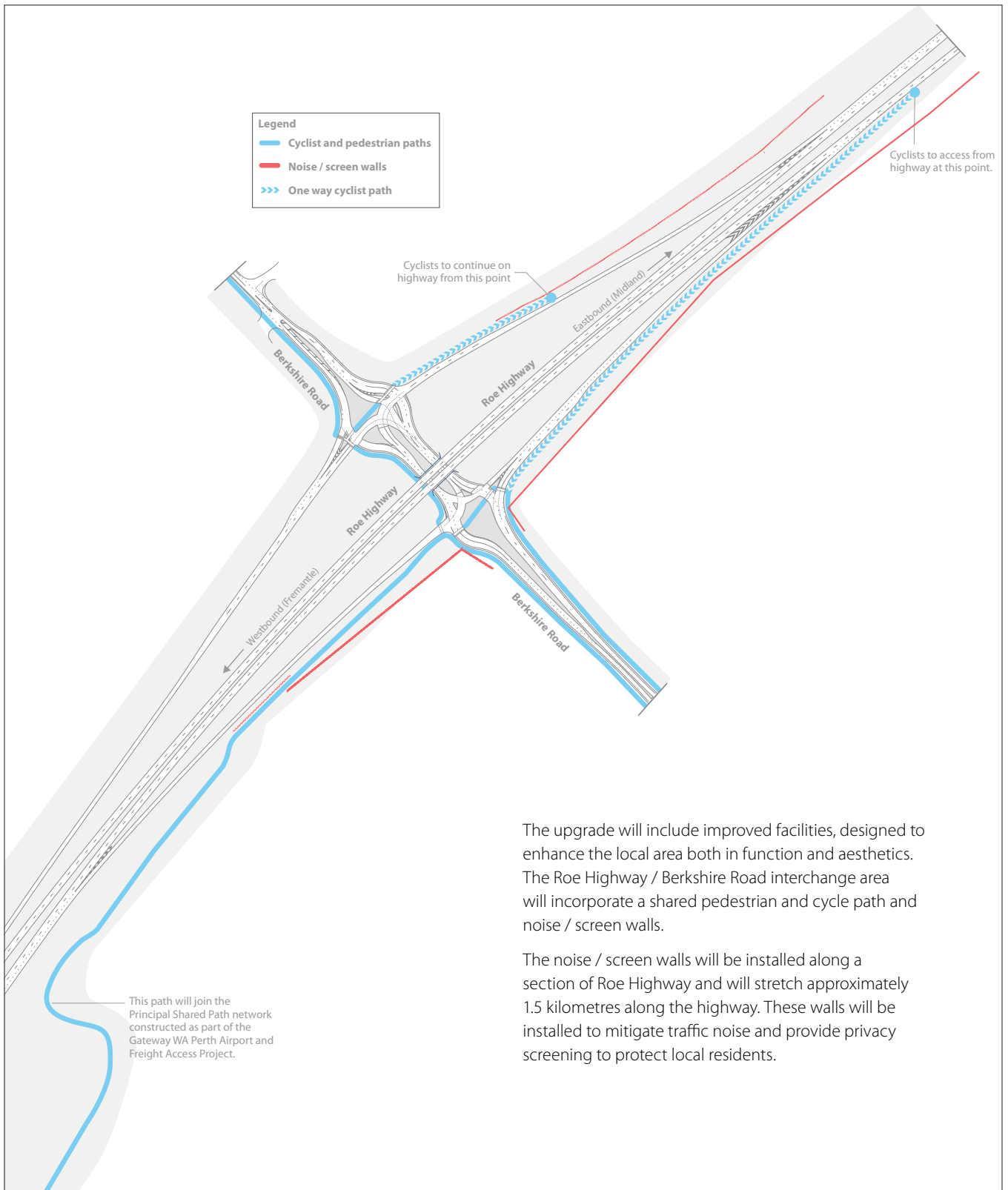

## FURTHER INFORMATION

If you would like to know more about the key features of the project please visit the Gateway WA website at [www.gatewaywa.com.au](http://www.gatewaywa.com.au)

## CONTACT US

If you have a question about the project you are welcome to contact the Gateway WA team on:  
Project Information Line: **1800 420 421** or  
email: [admin@gatewaywa.com.au](mailto:admin@gatewaywa.com.au)